

6' x 8' x var Utility Vault

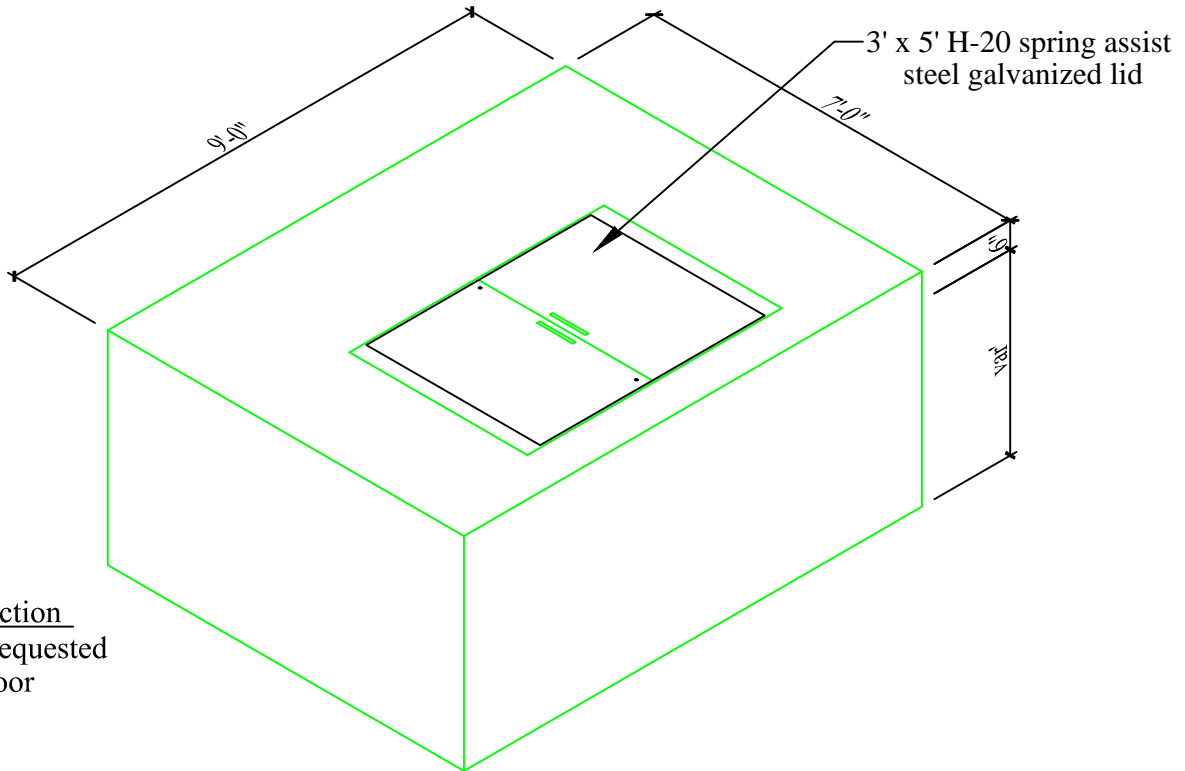

Bottom Section
 knockouts as requested
 10" drain in floor

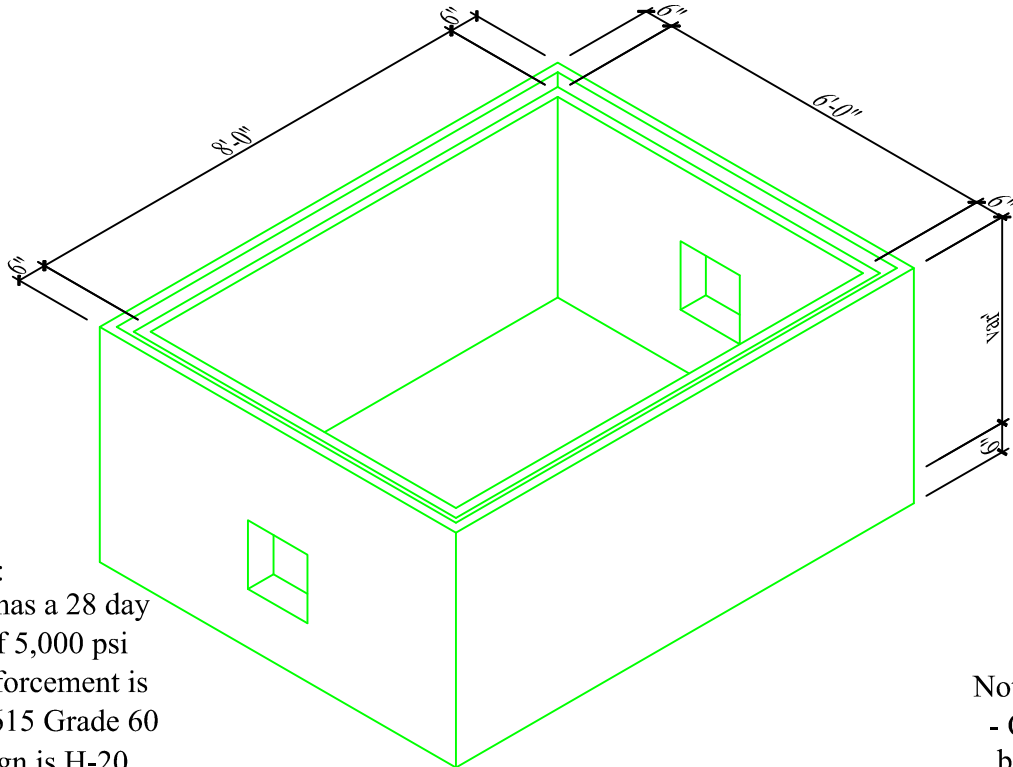

Approximate weight
 of base: 11,500 lbs
 at 3'-0" height

Specifications:

- Concrete has a 28 day strength of 5,000 psi
- Steel reinforcement is ASTM A615 Grade 60
- Load design is H-20

Notes:

- Consult manufacturer before handling



CAPITAL PRECAST, INC.

6905 SOUTH OLD BASTROP HWY
 SAN MARCOS, TEXAS 78666
 PH. (830) 606-6200

FOR 6' x 8' x var Utility Vault

JOB

DRAWN

RW

DATE

12/1/2015

Rev. No.

SHEET

FILE

catalog/vaults/6x8 Utility Vault

1 OF 1